

POTENTIAL STORAGE AREA

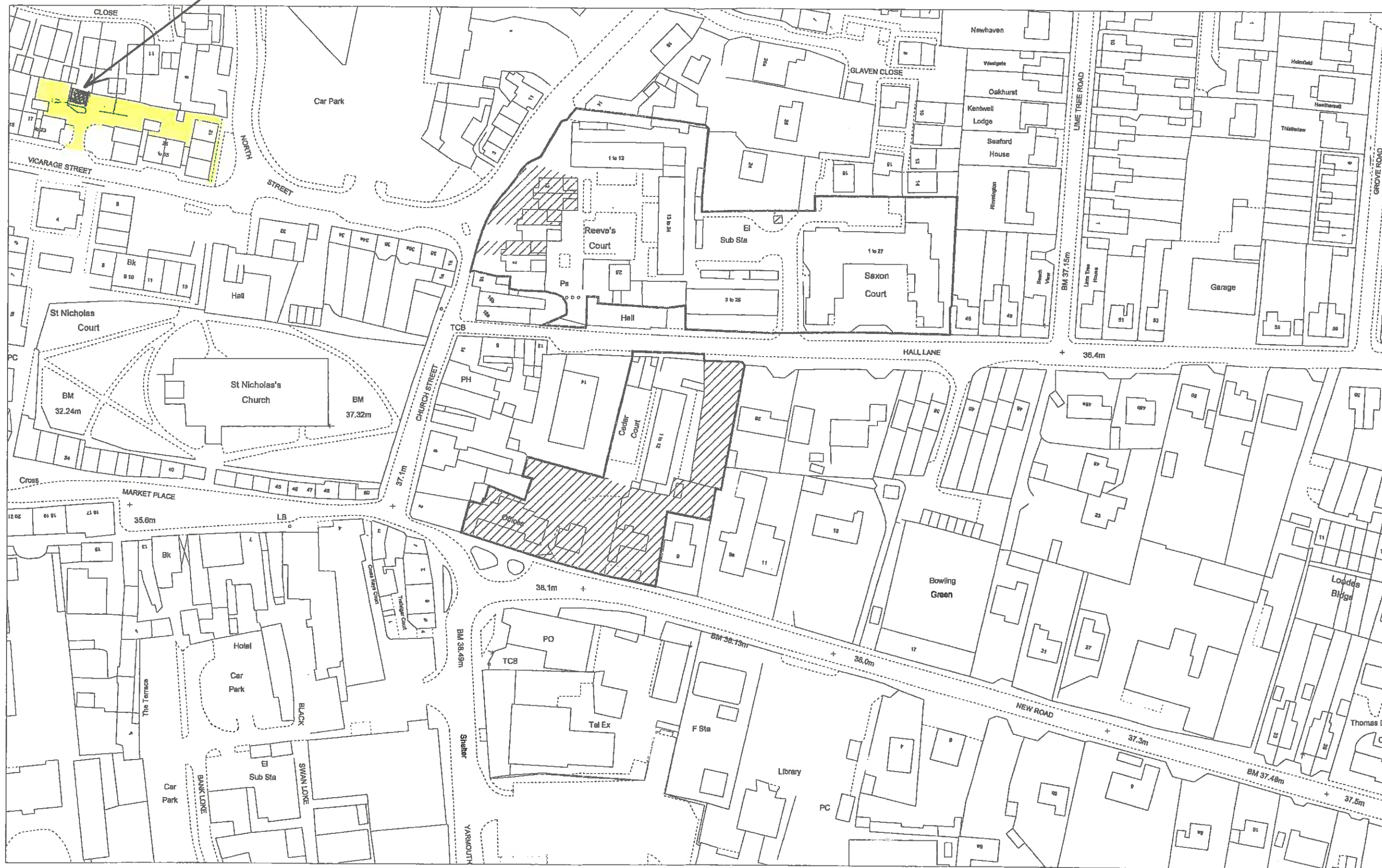

North Walsham - Drg. No. 166



Operator:	ML
Department:	Legal
Drawing No:	
Date: 14:12:05	Scale: 1:1250

This material has been reproduced from Ordnance Survey digital map data with the permission of the Controller of Her Majesty's Stationery Office. © Crown copyright.

OS Licence: 100045808

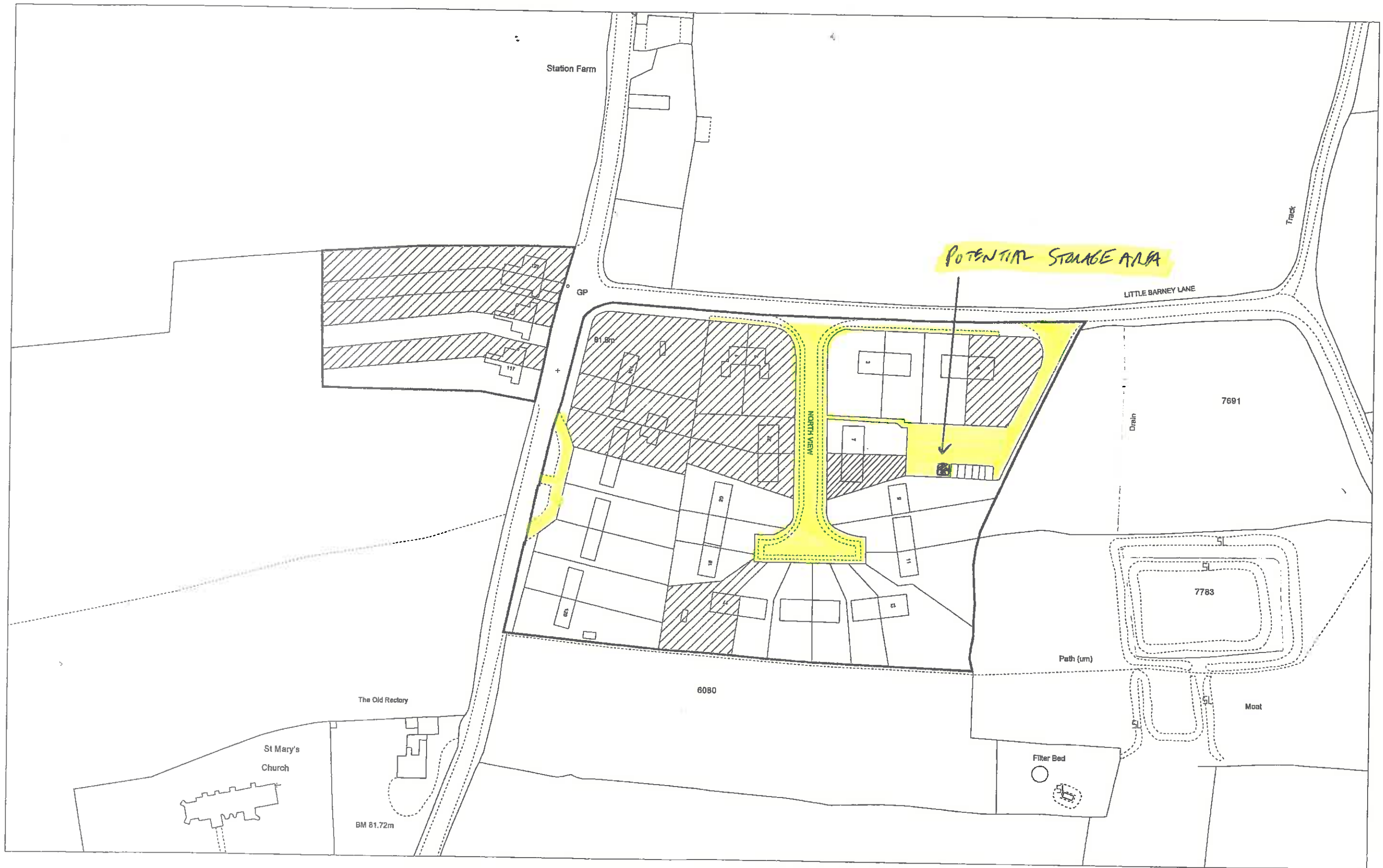

Barney - Drg. No. 16



Operator:	ML
Department:	Legal
Drawing No:	
Date: 07:12:05	Scale: 1:1250

This material has been reproduced from Ordnance Survey digital map data with the permission of the Controller of Her Majesty's Stationery Office. © Crown copyright.

OS Licence: 100045808

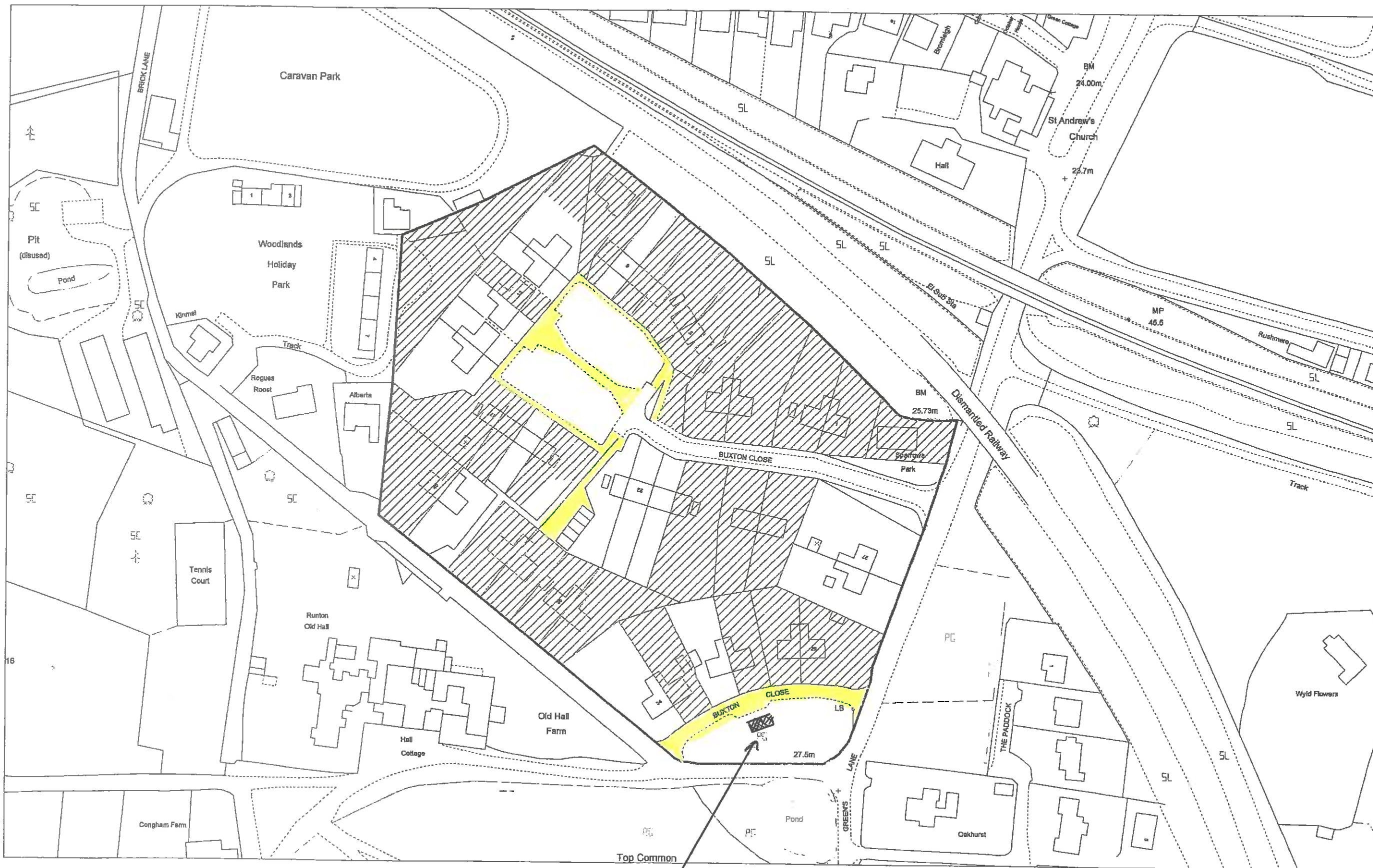

East Runton - Drg. No. 57

POTENTIAL
STORAGE
AREA



Operator:	ML
Department:	Legal
Drawing No:	
Date: 10:12:05	Scale: 1:1250

This material has been reproduced from Ordnance Survey digital map data with the permission of the Controller of Her Majesty's Stationary Office. © Crown copyright.

OS Licence: 100045808

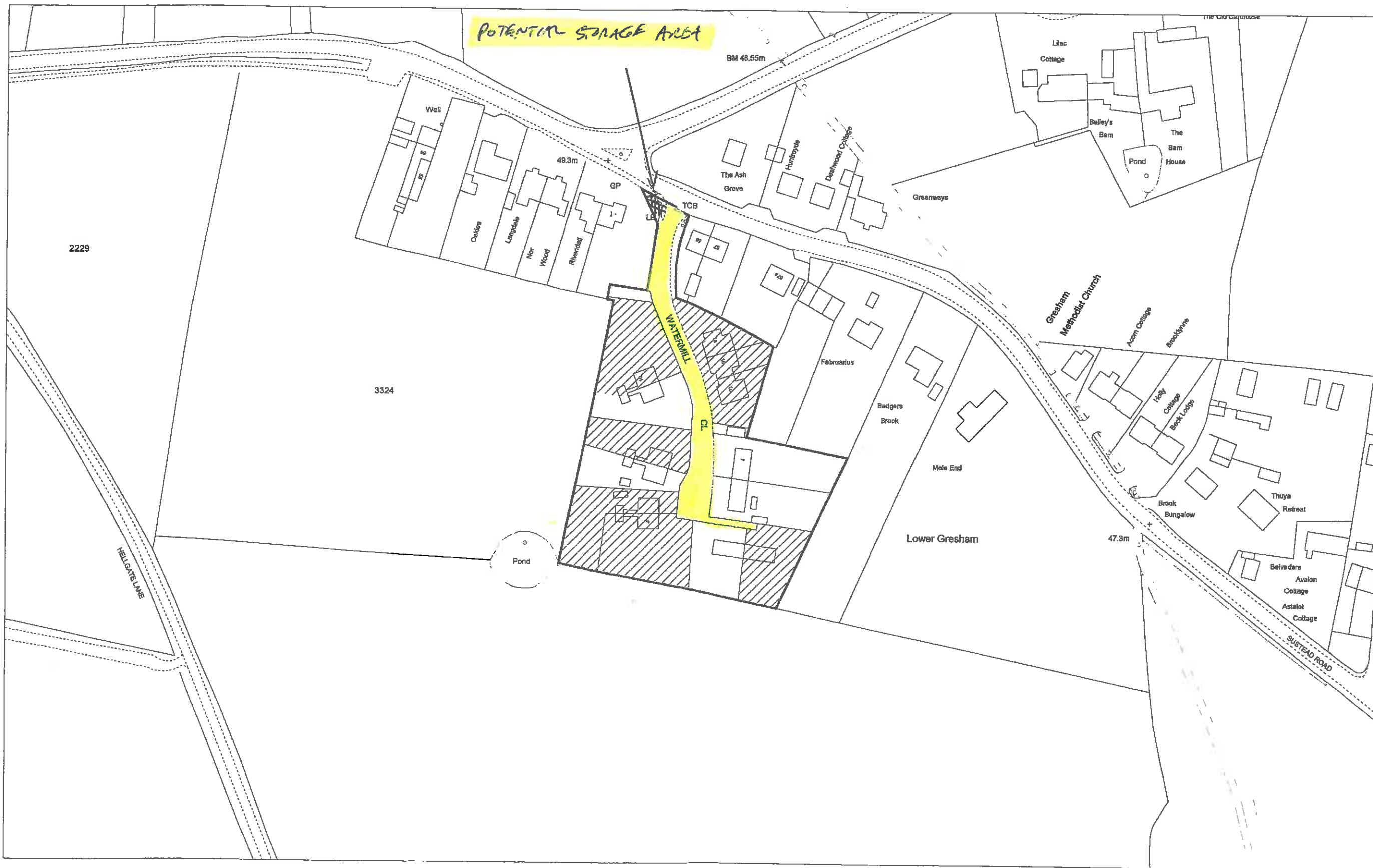

Gresham - Drg. No. 95



Operator:	ML
Department:	Legal
Drawing No:	
Date: 11:12:05	Scale: 1:1250

This material has been reproduced from Ordnance Survey digital map data with the permission of the Controller of Her Majesty's Stationary Office. © Crown copyright.

OS Licence: 100045808

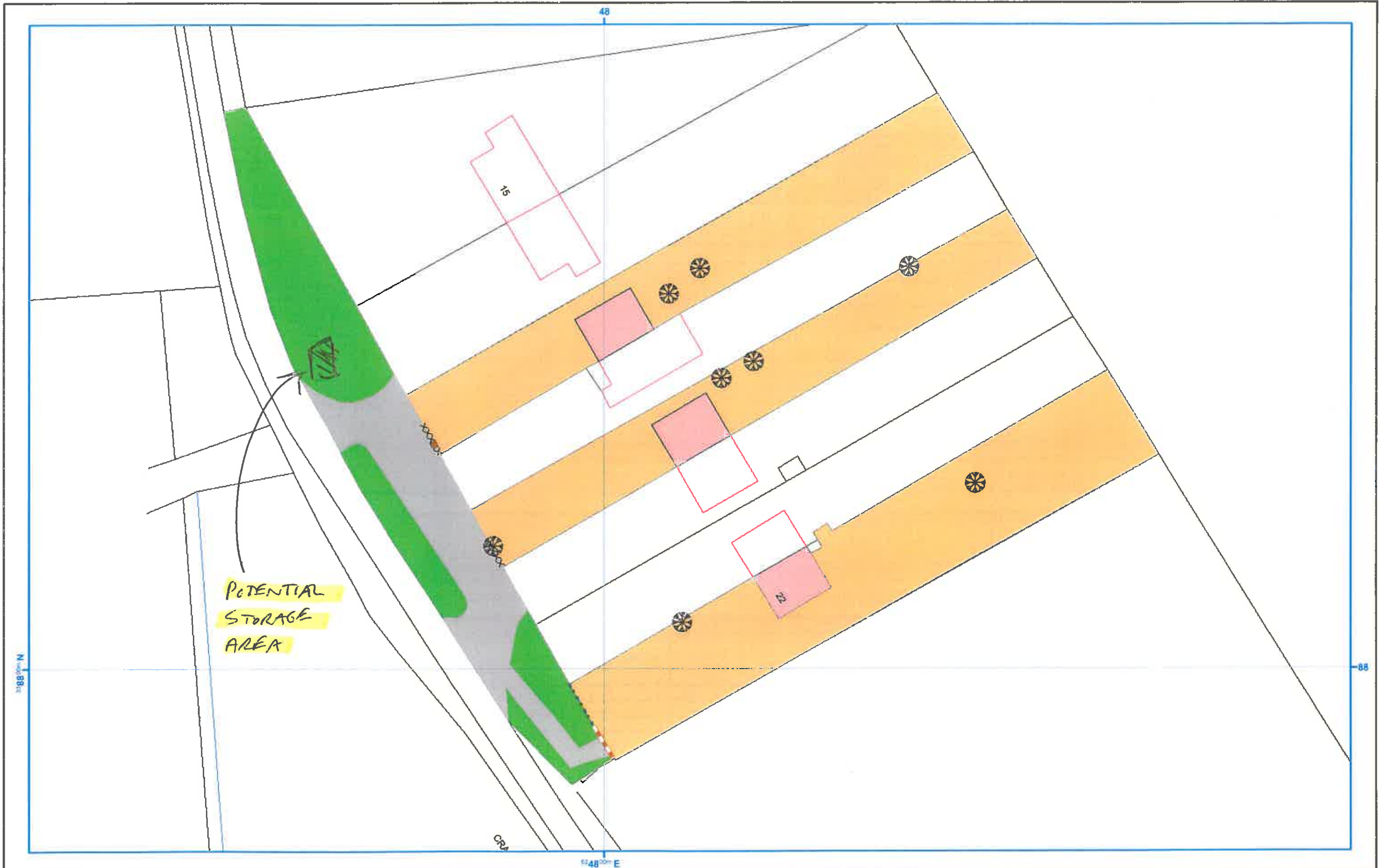



Horning - Drg. No. 123



Operator:	ML
Department:	Legal
Drawing No:	
Date: 11:12:05	Scale: 1:1250

This material has been reproduced from Ordnance Survey digital map data with the permission of the Controller of Her Majesty's Stationary Office. © Crown copyright.

OS Licence: 100045808